



Plots as drawn: 5 & 6

Handed: 7 & 8

97.11 sq m / 1045 sq ft

- * Reduced head height to WC
- * Reduced head space to store cupboard
- * Selected plots will have a window to W.C, hall plus first and second floor stairwells depending on property orientation

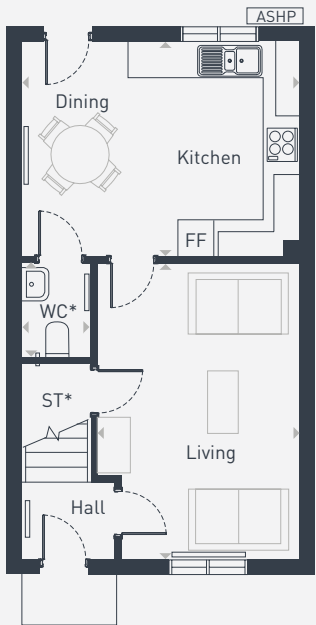

GROUND FLOOR

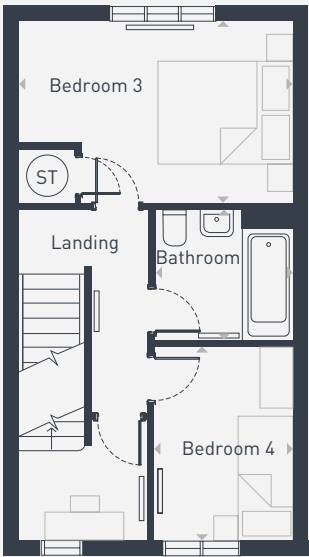

FIRST FLOOR

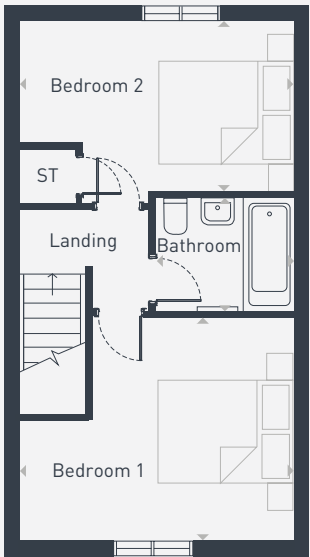

SECOND FLOOR

ST: Store WC: Water Closet ASHP: Air Source Heat Pump

DIMENSIONS	m	ft
Kitchen/Dining	4.09m x 3.26m	13'5" x 10'8"
Living	4.56m x 2.99m	14'11" x 9'9"
WC	1.43m x 0.97m	4'8" x 3'2"

DIMENSIONS	m	ft
Bedroom 1	4.09m max x 2.96m	13'5" max x 9'8"
Bedroom 2	4.09m max x 2.74m	13'5" max x 8'11"
Bedroom 3	2.99m max x 2.74m max	9'9" max x 8'11" max
Bedroom 4	2.99m x 1.90m	9'9" x 6'2"
Bathroom	2.04m x 1.98m	6'8" x 6'5"
Ensuite	1.99m x 1.97m	6'8" x 6'5"



0161 763 5066 | placesforpeople.co.uk/ropeworks
Brunswick Street, Heywood OL10 1EZ

Please note: All layouts and floor plans, configurations, maps and information are intended for guidance only and accuracy of this information cannot be relied upon by prospective purchasers who must make their own enquiries to satisfy themselves by inspection or otherwise as to the correct detail.