

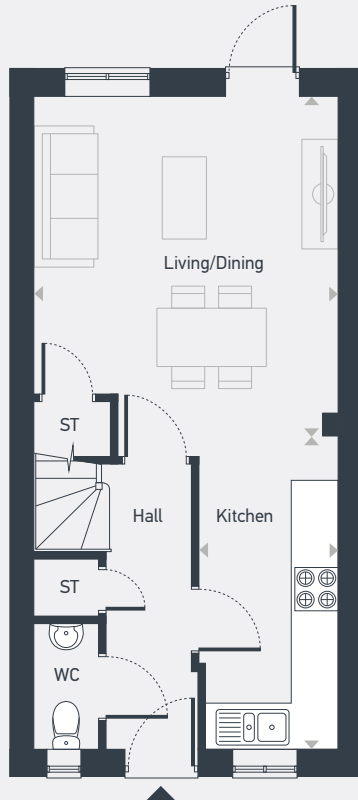

Plots as drawn: 73, 105, 109, 122 and 156
Handed: 72, 98, 106, 110, 121 and 157

802.6 sq. ft



GROUND FLOOR

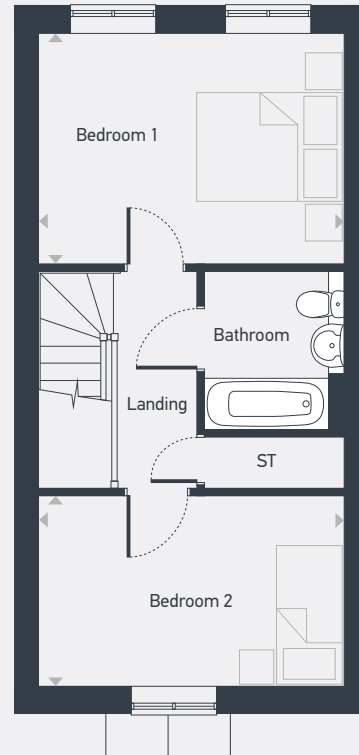

FIRST FLOOR

ST: Store WC: Water Closet

DIMENSIONS	m	ft
Living/Dining	4.65m x 4.17m	15'3" x 13'8"
Kitchen	4.30m x 1.90m	14'1" x 6'2"
Bedroom 1	4.17m x 3.16m	13'8" x 10'4"
Bedroom 2	4.17m x 2.61m	13'8" x 8'6"



01865 575 465 | placesforpeople.co.uk/meadowbrook
High Street, Chalgrove, Oxford OX44 7AF