

Plots as drawn: 133
Plots handed: 134

96 sq m / 1033 sq ft

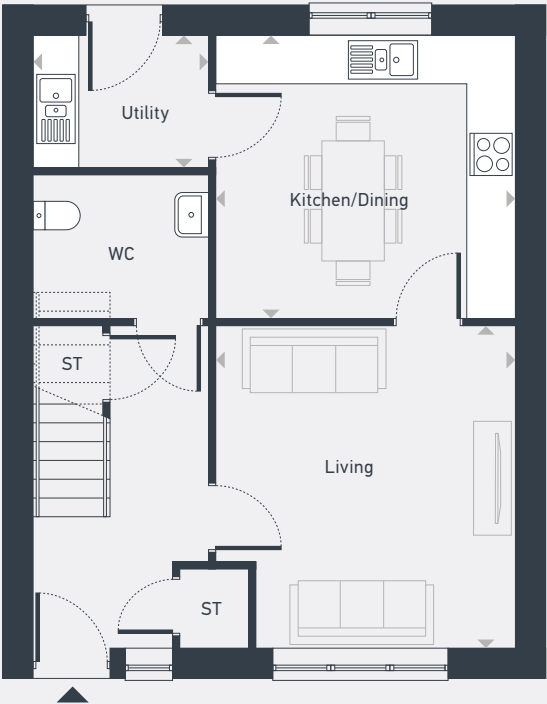

GROUND FLOOR

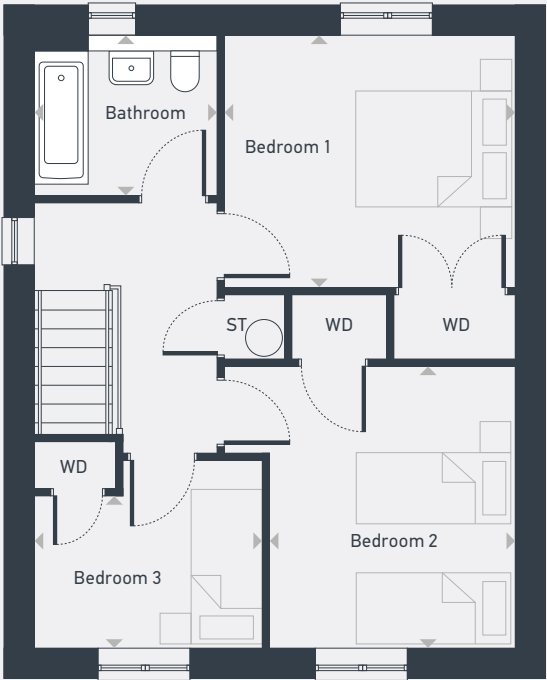

FIRST FLOOR

ST: Store WC: Water Closet WD: Wardrobe

DIMENSIONS	m	ft
Living	4.13m x 3.83m	13'6" x 12'7"
Kitchen/Dining	3.83m x 3.62m	12'7" x 11'10"
Utility	2.27m x 1.70m	7'5" x 5'7"

DIMENSIONS	m	ft
Bedroom 1	3.74m x 3.26m	12'3" x 10'8"
Bedroom 2	3.60m x 3.17m	11'10" x 10'5"
Bedroom 3	2.94m x 2.38m	9'8" x 7'10"
Bathroom	2.37m x 2.07m	7'9" x 6'9"



01569 730 980 | placesforpeople.co.uk/castlepark