

Abbeville Park

The Cardinham – Type 4 2 bedroom home

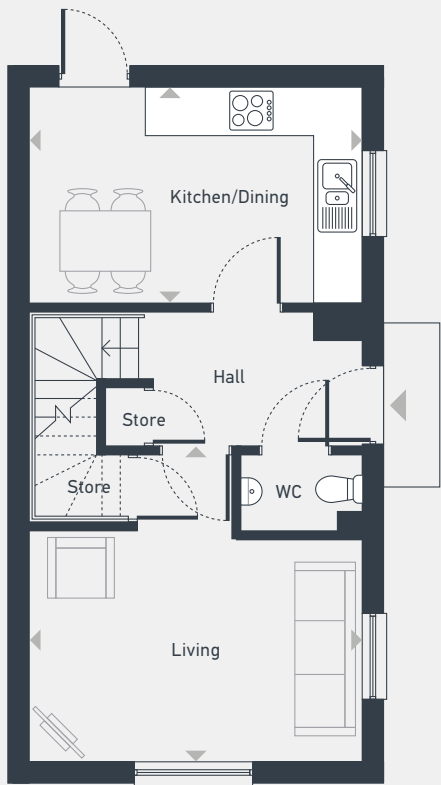



GROUND FLOOR

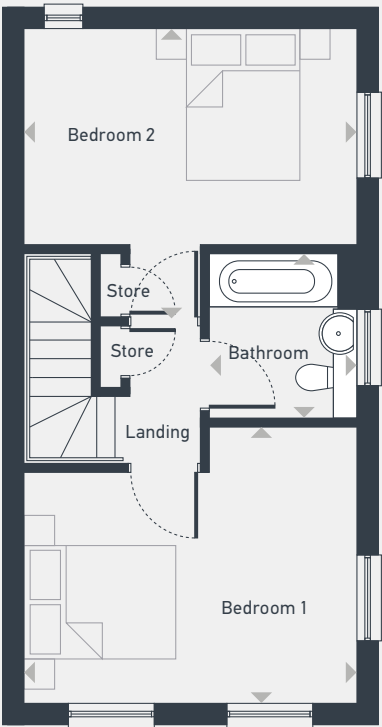

FIRST FLOOR

GROUND FLOOR	m	ft
Living	4.41m x 4.08m	14'6" x 13'4"
Kitchen/Dining	2.89m x 4.41m	9'5" x 14'6"

FIRST FLOOR	m	ft
Bedroom 1	4.41m x 3.68m	14'6" x 12'1"
Bedroom 2	4.40m x 3.81m	14'5" x 12'6"
Bathroom	2.15m x 1.95m	7'1" x 6'5"



01444 360 065 | placesforpeople.co.uk/abbevillepark
Abbeville Park, Fairbridge Way, Burgess Hill, West Sussex RH15 8BF