

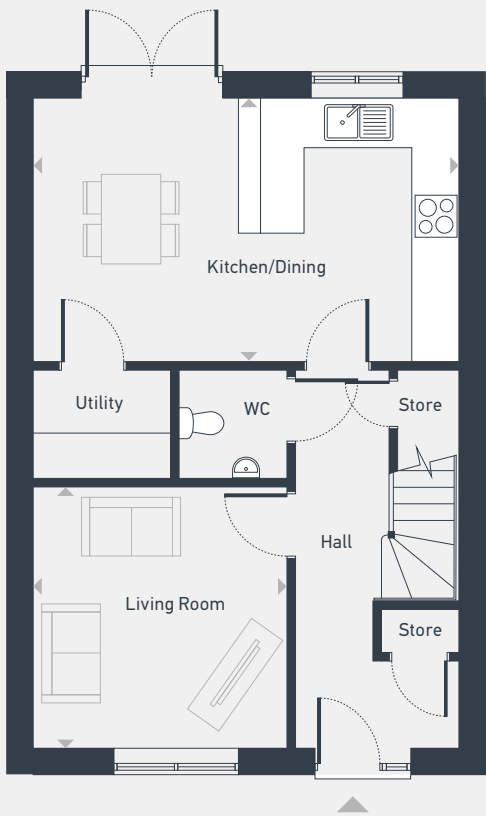

Plots 75, 76, 77 & 78 — semi-detached
Plots 75 & 77 — handed

102 sq m / 1,100 sq ft



GROUND FLOOR



FIRST FLOOR

| DIMENSIONS | m | ft |
|----------------|---------------|---------------|
| Kitchen/Dining | 5.82m x 3.63m | 19'1" x 11'9" |
| Living Room | 3.63m x 3.48m | 11'9" x 11'4" |

| DIMENSIONS | m | ft |
|------------|---------------|---------------|
| Bedroom 1 | 3.83m x 3.15m | 12'5" x 10'3" |
| En-suite | 3.15m x 1.92m | 10'3" x 6'4" |
| Bedroom 2 | 3.68m x 3.37m | 12'1" x 11'1" |
| Bedroom 3 | 3.68m x 2.39m | 12'1" x 7'8" |
| Bathroom | 2.23m x 1.99m | 7'3" x 6'5" |



01953 445 640 | sales@carversmeadow.co.uk | placesforpeople.co.uk/carversmeadow
Carvers Meadow, Carvers Lane, Attleborough, Norfolk NR17 1AB

Information correct as of August 2023

Please note: All CGIs, layouts and floor plans, configurations, maps and information are intended for guidance only and accuracy of this information cannot be relied upon by prospective purchasers who must make their own enquiries to satisfy themselves by inspection or otherwise as to the correct detail. Sizes and dimensions approximate and subject to change.