

Hawthorn Gardens at Lower Herne Village

The Vyne
2 bedroom home



Artist's Impression

Hawthorn Gardens at Lower Herne Village

The Vyne 2 bedroom home

Plots as drawn: 2, 11, 15, 98
Handed: 12, 14

70.3 sq.m / 757 sq.ft

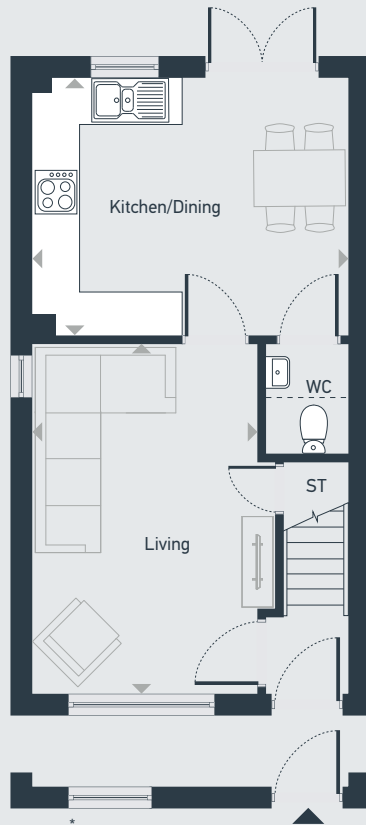

GROUND FLOOR

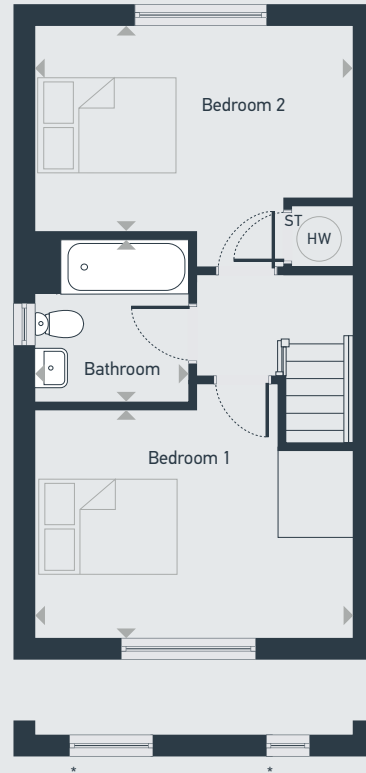

FIRST FLOOR

ST: Storage HW: Hot Water Cylinder * Windows to plot 2 & 98 only

DIMENSIONS	m	ft
Kitchen/Dining	4.22m x 3.25m	13'10" x 10'8"
Living	4.73m x 2.95m	15'6" x 9'8"

DIMENSIONS	m	ft
Bedroom 1	4.22m x 3.17m	13'10" x 10'5"
Bedroom 2	4.22m x 2.85m	13'10" x 9'4"
Bathroom	2.17m x 2.03m	7'1" x 6'7"



01227 387 085 | placesforpeople.co.uk/hawthorngardens
Email: hawthorngardens@placesforpeople.co.uk | 1 Furrows Place, Lower Herne, CT6 7YG

Please note: All layouts and floor plans, configurations, maps and information are intended for guidance only and accuracy of this information cannot be relied upon by prospective purchasers who must make their own enquiries to satisfy themselves by inspection or otherwise as to the correct detail. The artist's impression is intended as a guide only and that actual finishes may vary. For more details, please speak to your sales advisor.