

Plots as drawn: 131
Plots handed: 132

86 sq m / 926 sq ft

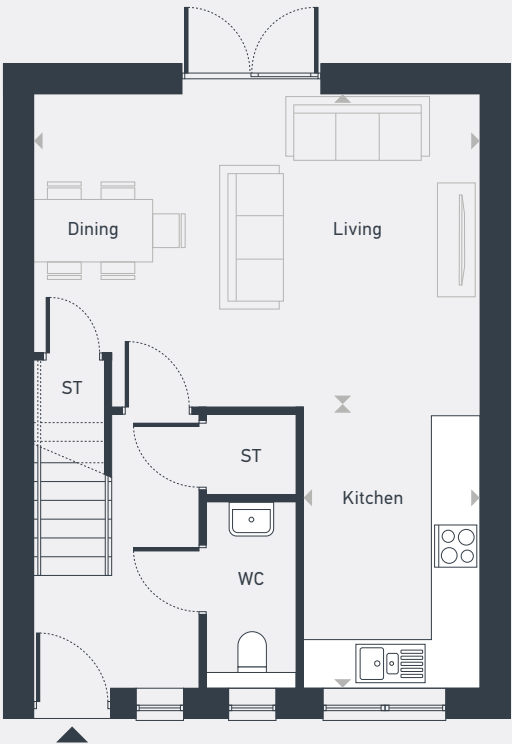

GROUND FLOOR

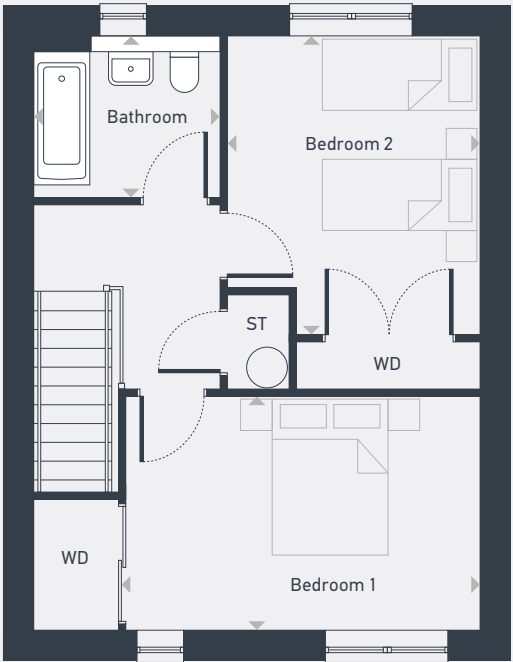

FIRST FLOOR

ST: Store WC: Water Closet WD: Wardrobe

DIMENSIONS	m	ft
Living/Dining	5.69m x 4.01m	18'8" x 13'2"
Kitchen	3.48m x 2.26m	11'5" x 7'5"

DIMENSIONS	m	ft
Bedroom 1	4.54m x 2.98m	14'11" x 9'9"
Bedroom 2	3.83m x 3.24m	12'7" x 10'7"
Bathroom	2.37m x 2.07m	7'9" x 6'9"



01569 730 980 | placesforpeople.co.uk/castlepark

Please note: All layouts and floor plans, configurations, maps and information are intended for guidance only and accuracy of this information cannot be relied upon by prospective purchasers who must make their own enquiries to satisfy themselves by inspection or otherwise as to the correct detail.