

Westhill

The Weekley 3 bedroom house



Westhill

The Weekley 3 bedroom house

Plots 382, 383, 384, 385, 386 & 387 — semi-detached
Plots 382, 384 & 386 — handed

98.6 sq m / 1061 sq ft



GROUND FLOOR

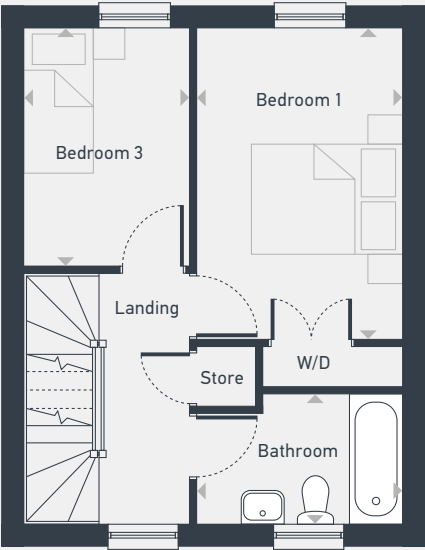

FIRST FLOOR

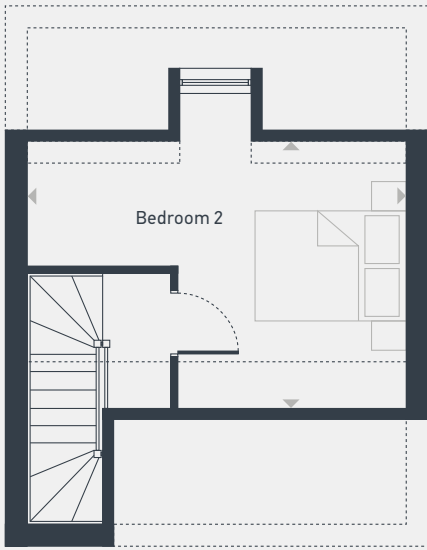

SECOND FLOOR

DIMENSIONS	m	ft
Lounge/Dining	4.85m x 4.47m	15'11" x 14'8"
Kitchen	4.19m x 2.78m	13'9" x 9'1"

DIMENSIONS	m	ft
Bedroom 1	4.34m x 2.72m	14'3" x 8'11"
Bedroom 3	3.52m x 2.15m	11'7" x 7'1"
Bathroom	2.72m x 1.94m	18'11" x 6'4"

DIMENSIONS	m	ft
Bedroom 2	4.94m x 4.68m	16'2" x 15'4"



01444 360 065 | placesforpeople.co.uk/westhill

Westhill, Foster Way, Kettering, Northamptonshire, NN15 7FF

Please note: All CGIs, layouts and floor plans, configurations, maps and information are intended for guidance only and accuracy of this information cannot be relied upon by prospective purchasers who must make their own enquiries to satisfy themselves by inspection or otherwise as to the correct detail. Sizes and dimensions approximate and subject to change.