

# Hartsdown Gardens

## The Barwick 2 bedroom home

---



# Hartsdown Gardens



## The Barwick 2 bedroom home

Plots as drawn: 37 and 38  
Handed: 39

70.02 sq m / 764 sq ft

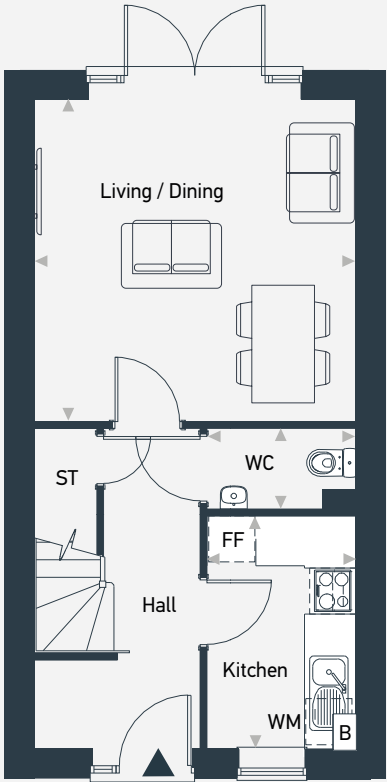

GROUND FLOOR

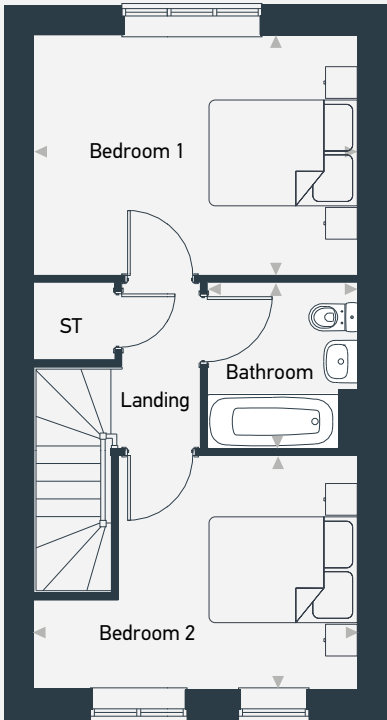

FIRST FLOOR

FF: Fridge / Freezer   WM: Washing Machine   ST: Store   WC: Water Closet   B: Boiler

DIMENSIONS	m	ft
Kitchen	3.70m x 1.98m	12'2" x 6'6"
Living/Dining	4.24m x 4.23m	13'11" x 13'11"
WC	1.98m x 1.07m	6'6" x 3'10"

DIMENSIONS	m	ft
Bedroom 1	4.19m x 3.11m	13'9" x 10'2"
Bedroom 2	4.19m x 3.06m	13'9" x 10'1"
Bathroom	2.17m x 1.99m	7'2" x 6'6"



[placesforpeople.co.uk/hartsdown-gardens](https://placesforpeople.co.uk/hartsdown-gardens)  
Hartsdown Road, Margate, Kent CT9 5QZ

Please note: All layouts and floor plans, configurations, maps and information are intended for guidance only and accuracy of this information cannot be relied upon by prospective purchasers who must make their own enquiries to satisfy themselves by inspection or otherwise as to the correct detail.