

The Willows at Aylesham

**The Rendlesham
3 bedroom home**



The Willows at Aylesham

The Rendlesham 3 bedroom home

Plots 64, 65, 66 & 67

85.7 sq m / 923 sq ft

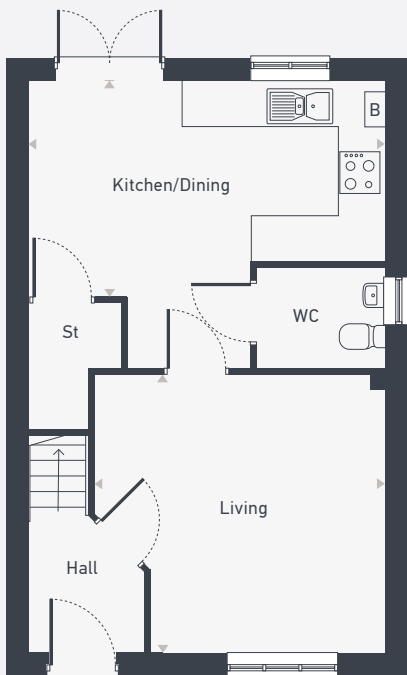

GROUND FLOOR



FIRST FLOOR

GROUND FLOOR	m	ft
Kitchen/Dining	5.11m x 3.10m	16'9" x 10'2"
Living	4.17m x 4.01m	13'8" x 13'2"

FIRST FLOOR	m	ft
Bedroom 1	5.11m x 2.84m	16'10" x 9'4"
Bedroom 2	3.10m x 2.70m	10'2" x 8'10"
Bedroom 3	3.10m x 2.32m	10'2" x 7'8"



Central Boulevard, Aylesham, Canterbury, CT3 3FF
placesforpeople.co.uk/thewillows

Please note: All layouts and floor plans, configurations, maps and information are intended for guidance only and accuracy of this information cannot be relied upon by prospective purchasers who must make their own enquiries to satisfy themselves by inspection or otherwise as to the correct detail. Sizes and dimensions approximate and subject to change.