

White House Park

The Ellingham 3 bedroom house

Plots 121, 135, 137, 144 & 146 — end-terrace
Plot 159 — semi-detached
Plots 121, 137 & 146 — handed

93.5 sq m / 1006 sq ft

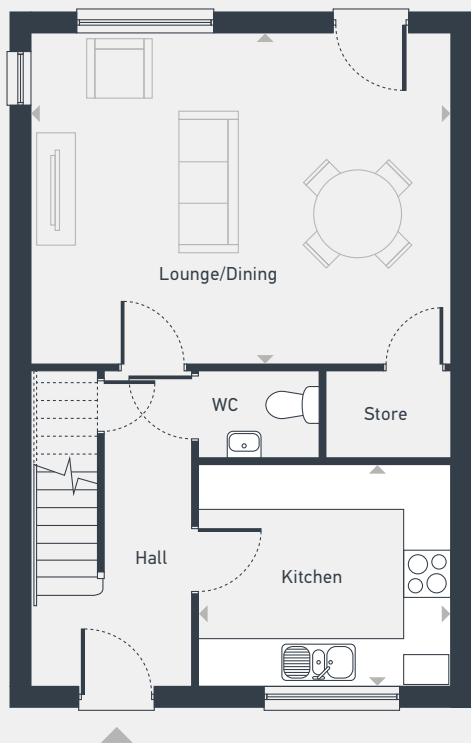

GROUND FLOOR

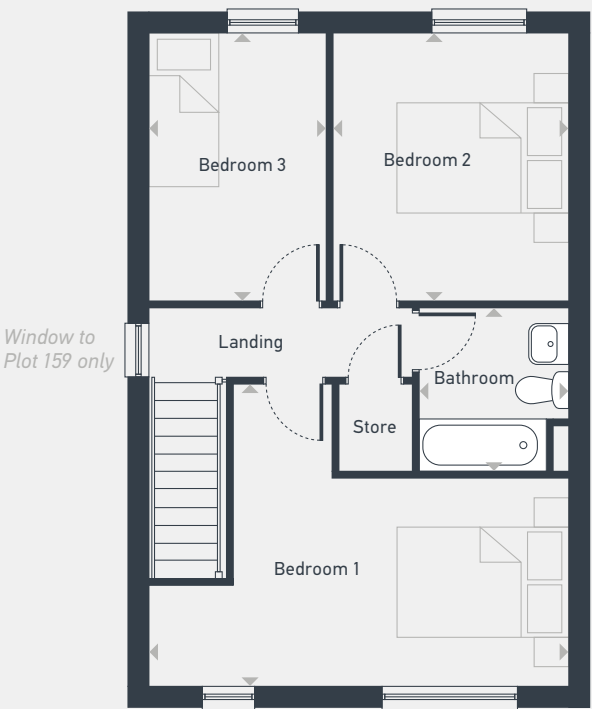

FIRST FLOOR

DIMENSIONS	m	ft
Lounge/Dining	5.54m x 4.40m	18'2" x 14'5"
Kitchen	3.34m x 2.94m	10'11" x 9'8"

DIMENSIONS	m	ft
Bedroom 1	5.54m x 4.00m	18'2" x 13'1"
Bedroom 2	3.56m x 3.12m	11'8" x 10'3"
Bedroom 3	3.56m x 2.36m	11'8" x 7'9"
Bathroom	2.18m x 2.00m	7'2" x 6'7"



07771 160 268 | placesforpeople.co.uk/whitehousepark

White House Park, Buckenham Road, Attleborough, Norfolk, NR17 1NB

Please note: All layouts and floor plans, configurations, maps and information are intended for guidance only and accuracy of this information cannot be relied upon by prospective purchasers who must make their own enquiries to satisfy themselves by inspection or otherwise as to the correct detail. Sizes and dimensions approximate and subject to change.